



**art.CFB/HR.. LONG SERIES ROTATING BRONZE FLANGE NUTS TR20/60** accessorised for transmitting drive.

**NUT MATERIAL:** Bronze CuSn12 UNI 7013-72 (R 300 N/mm<sup>2</sup>, HB 90/100).

**MATERIAL:** Paired bevel gears ratio 1:1 and 1:2, simple Pinions and double, cogwheels, C45 UNI 7847

The above CFB/HR.. are fitted in the mobile Platforms inside of Supports LXR of the Rotary nut series and are available individually as spare parts.

The Bevel gears, the Pinions, the Cogwheels, **on request can be supplied with nitriding surface treatment** to guarantee less wear.

**Before asking for the nuts or other spare part components we suggest considering the possibility of sending the complete Platform or support to Bimeccanica who will perform a complete overhaul replacing any worn parts.**

**SPARE PARTS FOR ROTARY SUPPORTS:**

Rotary nut with paired bevel gears ratio 1:1 art.CFB/HR..+CC1:1

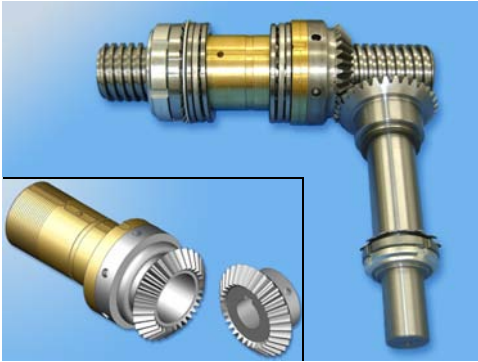

Nuts with RIGHT thread available from stock; nuts with LEFT thread (special) made to order.

ROTATING NUT	CODE Dx	ARTICLE Dx	CODE Sx (special)	ARTICLE Sx (special)
TR 20x4	303SRC00204R	CFB/HR204+CC1:1	303SRC00204L	CFB/HR204L+CC1:1 Sx
TR 25x5	303SRC00255R	CFB/HR255+CC1:1	303SRC00255L	CFB/HR255L+CC1:1 Sx
TR 30x6	303SRC00306R	CFB/HR306+CC1:1	303SRC00306L	CFB/HR306L+CC1:1 Sx
TR 35x6	303SRC00356R	CFB/HR356+CC1:1	303SRC00356L	CFB/HR356L+CC1:1 Sx
TR 36x6	303SRC00366R	CFB/HR366+CC1:1	303SRC00366L	CFB/HR366L+CC1:1 Sx
TR 40x7	303SRC00407R	CFB/HR407+CC1:1	303SRC00407L	CFB/HR407L+CC1:1 Sx
TR 45x8	303SRC00458R	CFB/HR458+CC1:1	303SRC00458L	CFB/HR458L+CC1:1 Sx
TR 50x8	303SRC00508R	CFB/HR508+CC1:1	303SRC00508L	CFB/HR508L+CC1:1 Sx
TR 55x9	303SRC00559R	CFB/HR559+CC1:1	303SRC00559L	CFB/HR559L+CC1:1 Sx
TR 60x9	303SRC00609R	CFB/HR609+CC1:1	303SRC00609L	CFB/HR609L+CC1:1 Sx

TR 20x4	303SRC01204R	CFB/HR204+CC1:2	303SRC01204L	CFB/HR204L+CC1:2 Sx
TR 25x5	303SRC01255R	CFB/HR255+CC1:2	303SRC01255L	CFB/HR255L+CC1:2 Sx
TR 30x6	303SRC01306R	CFB/HR306+CC1:2	303SRC01306L	CFB/HR306L+CC1:2 Sx
TR 35x6	303SRC01356R	CFB/HR356+CC1:2	303SRC01356L	CFB/HR356L+CC1:2 Sx
TR 36x6	303SRC01366R	CFB/HR366+CC1:2	303SRC01366L	CFB/HR366L+CC1:2 Sx
TR 40x7	303SRC01407R	CFB/HR407+CC1:2	303SRC01407L	CFB/HR407L+CC1:2 Sx
TR 45x8	303SRC01458R	CFB/HR458+CC1:2	303SRC01458L	CFB/HR458L+CC1:2 Sx
TR 50x8	303SRC01508R	CFB/HR508+CC1:2	303SRC01508L	CFB/HR508L+CC1:2 Sx
TR 55x9	303SRC01559R	CFB/HR559+CC1:2	303SRC01559L	CFB/HR559L+CC1:2 Sx
TR 60x9	303SRC01609R	CFB/HR609+CC1:2	303SRC01609L	CFB/HR609L+CC1:2 Sx

TR 20x4	303SRC02204R	CFB/HR204+PS	303SRC02204L	CFB/HR204L+PS Sx
TR 25x5	303SRC02255R	CFB/HR255+PS	303SRC02255L	CFB/HR255L+PS Sx
TR 30x6	303SRC02306R	CFB/HR306+PS	303SRC02306L	CFB/HR306L+PS Sx
TR 35x6	303SRC02356R	CFB/HR356+PS	303SRC02356L	CFB/HR356L+PS Sx
TR 36x6	303SRC02366R	CFB/HR366+PS	303SRC02366L	CFB/HR366L+PS Sx
TR 40x7	303SRC02407R	CFB/HR407+PS	303SRC02407L	CFB/HR407L+PS Sx
TR 45x8	303SRC02458R	CFB/HR458+PS	303SRC02458L	CFB/HR458L+PS Sx
TR 50x8	303SRC02508R	CFB/HR508+PS	303SRC02508L	CFB/HR508L+PS Sx
TR 55x9	303SRC02559R	CFB/HR559+PS	303SRC02559L	CFB/HR559L+PS Sx
TR 60x9	303SRC02609R	CFB/HR609+PS	303SRC02609L	CFB/HR609L+PS Sx

TR 20x4	303SRC03204R	CFB/HR204+PD	303SRC03204L	CFB/HR204L+PD Sx
TR 25x5	303SRC03255R	CFB/HR255+PD	303SRC03255L	CFB/HR255L+PD Sx
TR 30x6	303SRC03306R	CFB/HR306+PD	303SRC03306L	CFB/HR306L+PD Sx
TR 35x6	303SRC03356R	CFB/HR356+PD	303SRC03356L	CFB/HR356L+PD Sx
TR 36x6	303SRC03366R	CFB/HR366+PD	303SRC03366L	CFB/HR366L+PD Sx
TR 40x7	303SRC03407R	CFB/HR407+PD	303SRC03407L	CFB/HR407L+PD Sx
TR 45x8	303SRC03458R	CFB/HR458+PD	303SRC03458L	CFB/HR458L+PD Sx
TR 50x8	303SRC03508R	CFB/HR508+PD	303SRC03508L	CFB/HR508L+PD Sx
TR 55x9	303SRC03559R	CFB/HR559+PD	303SRC03559L	CFB/HR559L+PD Sx
TR 60x9	303SRC03609R	CFB/HR609+PD	303SRC03609L	CFB/HR609L+PD Sx

TR 20x4	303SRC04204R	CFB/HR204+RD	303SRC04204L	CFB/HR204L+RD Sx
TR 25x5	303SRC04255R	CFB/HR255+RD	303SRC04255L	CFB/HR255L+RD Sx
TR 30x6	303SRC04306R	CFB/HR306+RD	303SRC04306L	CFB/HR306L+RD Sx
TR 35x6	303SRC04356R	CFB/HR356+RD	303SRC04356L	CFB/HR356L+RD Sx
TR 36x6	303SRC04366R	CFB/HR366+RD	303SRC04366L	CFB/HR366L+RD Sx
TR 40x7	303SRC04407R	CFB/HR407+RD	303SRC04407L	CFB/HR407L+RD Sx
TR 45x8	303SRC04458R	CFB/HR458+RD	303SRC04458L	CFB/HR458L+RD Sx
TR 50x8	303SRC04508R	CFB/HR508+RD	303SRC04508L	CFB/HR508L+RD Sx
TR 55x9	303SRC04559R	CFB/HR559+RD	303SRC04559L	CFB/HR559L+RD Sx
TR 60x9	303SRC04609R	CFB/HR609+RD	303SRC04609L	CFB/HR609L+RD Sx

Rotary nut with paired Bevel gears ratio 1:2 art.CFB/HR..+CC1:2-SGR

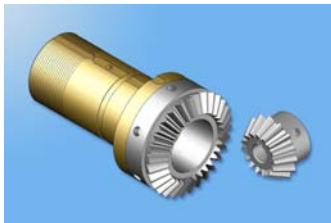

Rotary nut with simple Pinion for chain art.CFB/HR..+PS-SGR



Rotary nut with double Pinion for chain art.CFB/HR..+PD-SGR

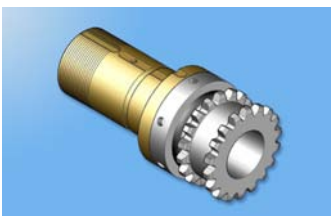

Rotary nut with cylindrical Cogwheel art.CFB/HR..+RD-SGR

