

# ŠPIRÁLOVÉ SPOJKY

# WKAK



Bezvôľové špirálové spojky so zverným nábojom

Materiál: hliník, pochrómovaný

Vyrobený z jedného kusa materiálu

skrutka s valcovou hlavou DIN912

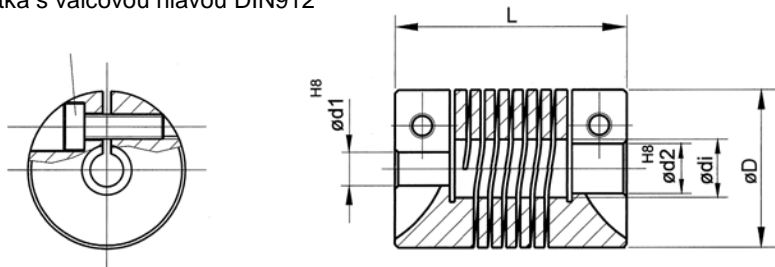

| Typ             | Vrtanie d1/d2 |      | Priemer<br>D | Dĺžka<br>L | Nastav.<br>skrutka |
|-----------------|---------------|------|--------------|------------|--------------------|
|                 | min.          | max. |              |            |                    |
| WKAK 1421 02/02 | 2             | 2    | 14           | 21         | M2x6               |
| WKAK 1421 02/03 | 2             | 3    | 14           | 21         | M2x6               |
| WKAK 1421 03/03 | 3             | 3    | 14           | 21         | M2x6               |
| WKAK 1421 03/04 | 3             | 4    | 14           | 21         | M2x6               |
| WKAK 1421 04/04 | 4             | 4    | 14           | 21         | M2x6               |
|                 |               |      |              |            |                    |
| WKAK 1625 03/03 | 3             | 3    | 16           | 25         | M2x6               |
| WKAK 1625 03/05 | 3             | 5    | 16           | 25         | M2x6               |
| WKAK 1625 04/04 | 4             | 4    | 16           | 25         | M2x6               |
| WKAK 1625 05/05 | 5             | 5    | 16           | 25         | M2x6               |
|                 |               |      |              |            |                    |
| WKAK 1928 04/04 | 4             | 4    | 19           | 28         | M3x10              |
| WKAK 1928 04/06 | 4             | 6    | 19           | 28         | M3x10              |
| WKAK 1928 05/05 | 5             | 5    | 19           | 28         | M3x10              |
| WKAK 1928 05/06 | 5             | 6    | 19           | 28         | M3x10              |
| WKAK 1928 06/06 | 6             | 6    | 19           | 28         | M3x10              |

| Typ             | Vrtanie d1/d2 |      | Priemer<br>D | Dĺžka<br>L | Nastav.<br>skrutka |
|-----------------|---------------|------|--------------|------------|--------------------|
|                 | min.          | max. |              |            |                    |
| WKAK 2532 06/06 | 6             | 6    | 25           | 32         | M3x10              |
| WKAK 2532 06/08 | 6             | 8    | 25           | 32         | M3x10              |
| WKAK 2532 06/10 | 6             | 10   | 25           | 32         | M3x10              |
| WKAK 2532 08/08 | 8             | 8    | 25           | 32         | M3x10              |
| WKAK 2532 08/10 | 8             | 10   | 25           | 32         | M3x10              |
| WKAK 2532 10/10 | 10            | 10   | 25           | 32         | M3x10              |
| WKAK 2532 10/12 | 10            | 12   | 25           | 32         | M3x10              |
|                 |               |      |              |            |                    |
| WKAK 3038 10/10 | 10            | 10   | 30           | 38         | M4x12              |
| WKAK 3038 12/12 | 12            | 12   | 30           | 38         | M4x12              |
| WKAK 3038 14/14 | 14            | 14   | 30           | 38         | M4x12              |

| Typ                                     | WKAK 1421 | WKAK 1625 | WKAK 1928 | WKAK 2532 | WKAK 3038 |
|---|-----------|-----------|-----------|-----------|-----------|
| Max. otáčky [min-1]                     | 6.000     | 6.000     | 6.000     | 6.000     | 6.000     |
| Max. krútiaci moment [Ncm]              | 50        | 60        | 80        | 120       | 150       |
| Max. vyosenie hriadeľov                 | -         | -         | -         | -         | -         |
| radiálne [mm]                           | ±0,2      | ±0,2      | ±0,25     | ±0,35     | ±0,35     |
| axiálne [mm]                            | ±0,25     | ±0,3      | ±0,4      | ±0,5      | ±0,5      |
| uhol [stupeň]                           | ±3        | ±3,5      | ±4        | ±4        | ±0,4      |
| Tuhosť pružín v krute [Nm/rad]          | 4,5       | 5,5       | 8         | 16        | 19        |
| Radiálna tuhosť pružín [N/[mm]]         | 22        | 30        | 36        | 45        | 60        |
| Moment zotrvačnosti [gcm <sup>2</sup> ] | 1,9       | 3,8       | 8,7       | 29        | 76        |
| Max. moment skrutiek [Ncm]              | 50        | 50        | 80        | 100       | 100       |
| Hmotnosť [g]                            | 6,5       | 10        | 16        | 34        | 58        |